

AutoCAD® 2013

A

B

C

D

E

F



TABELLA PIANA IN ALLUMINIO SP.20/10



SCALA 1:5

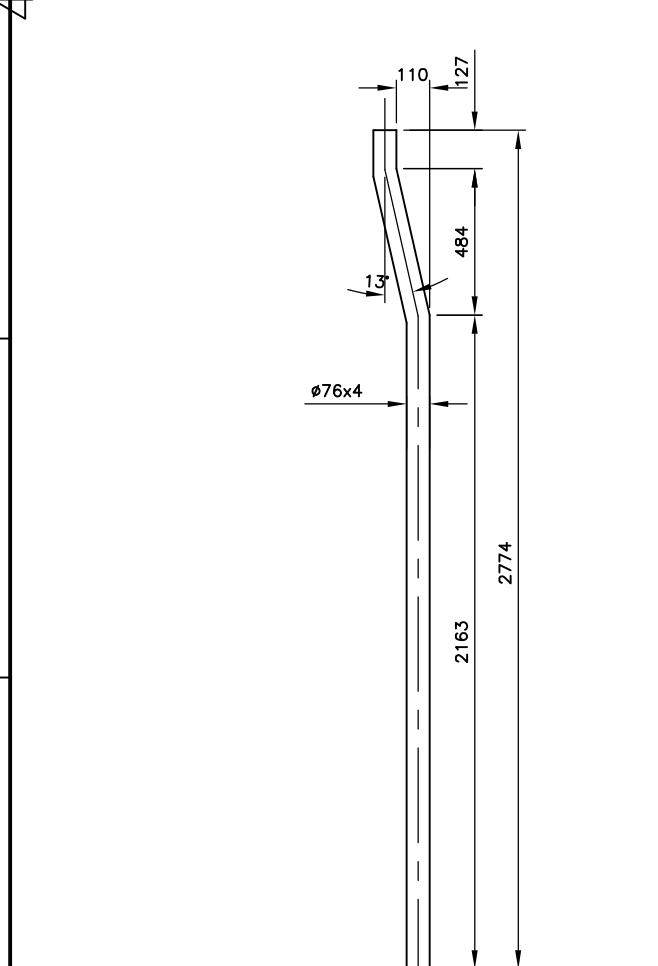
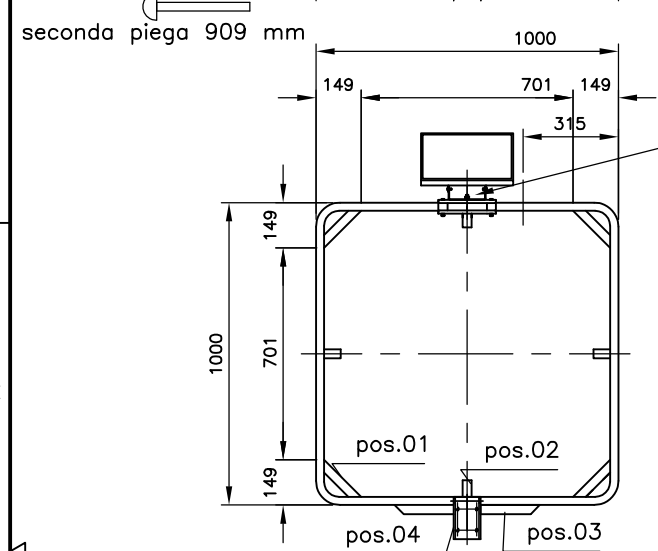
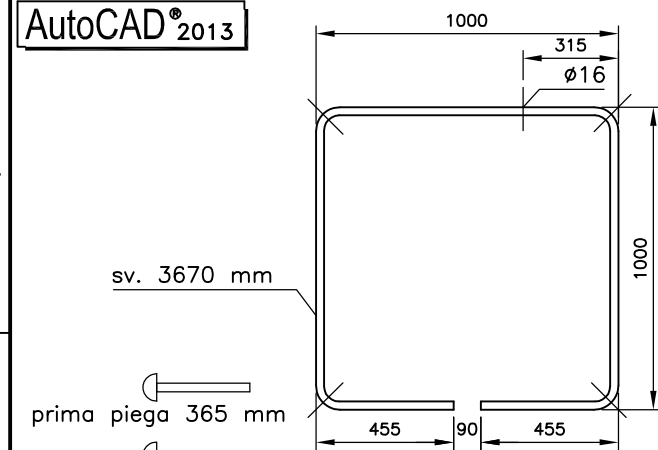
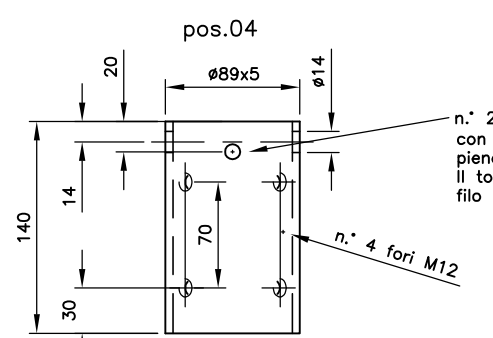
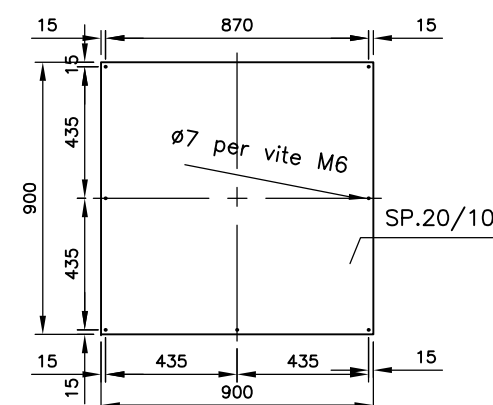
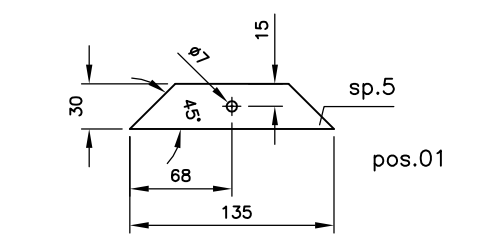
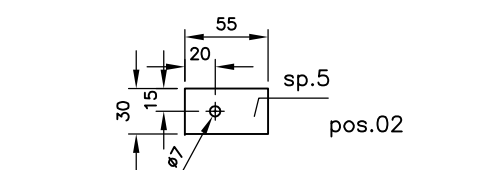
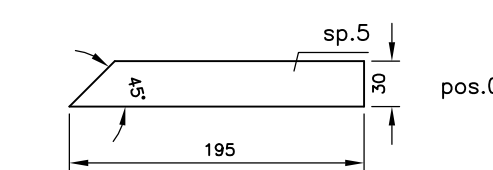

SCALA 1:5

S.O.S. SU CARREGGIATA AUTOSTRADALE

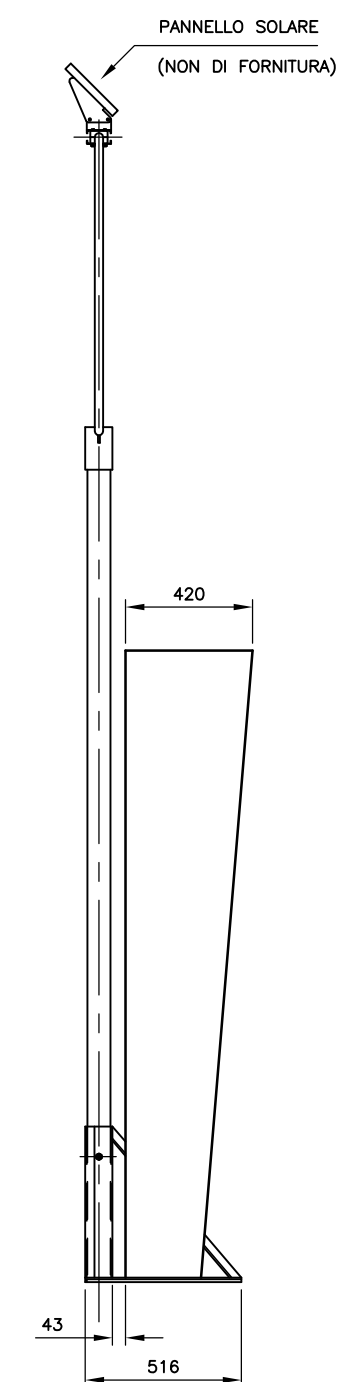
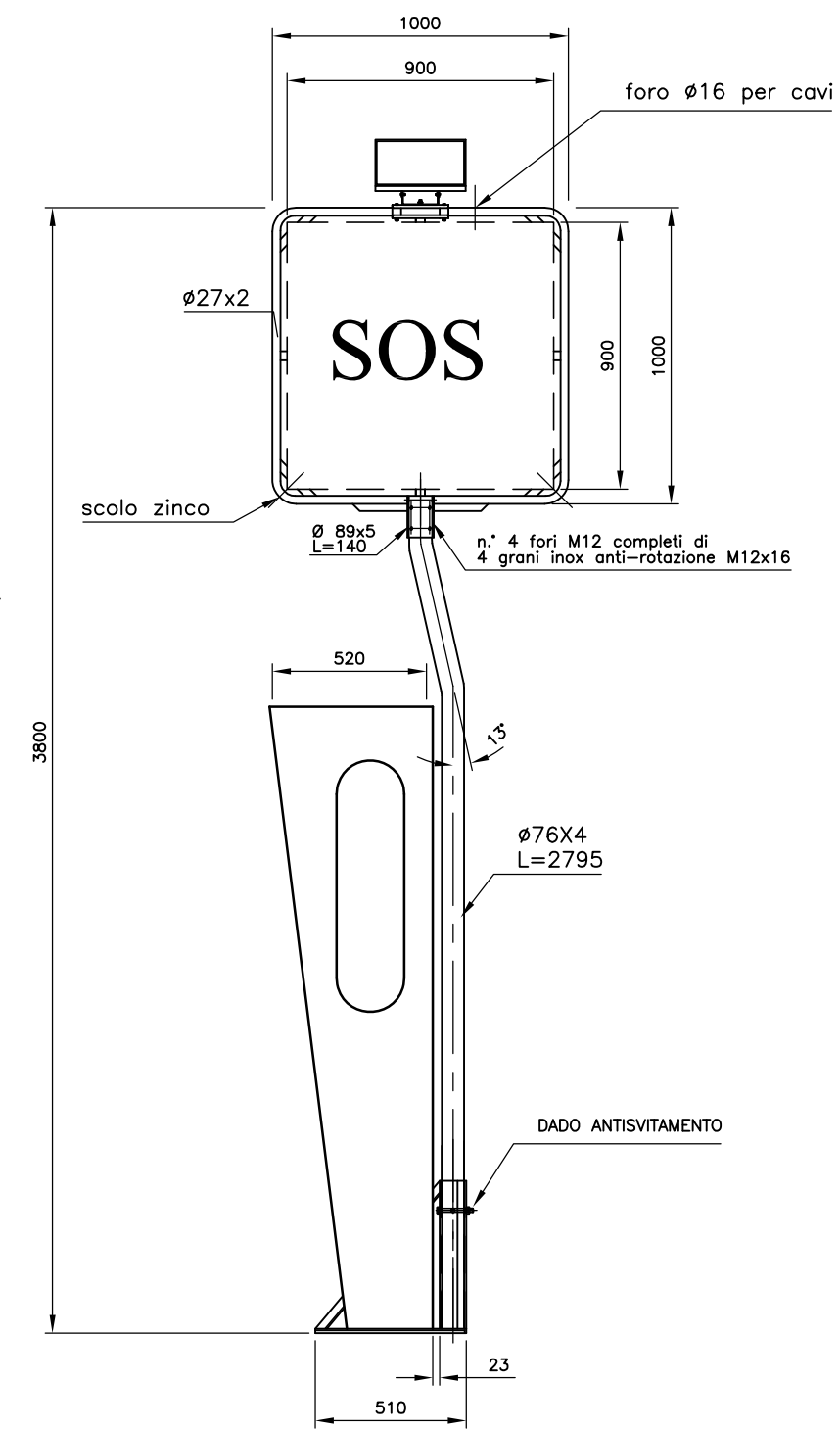

Disegnato da:	Titolo: COLONNINA S.O.S. GSM		
Data disegno: 18/07/05	Palo e tabellone.		
Approvato da:	Materiale: S235 (FE 360 B)		Dis. N° M-0000-0012-05
Data approv.:	Peso:		File: PROGETTO PALO
Rev.: 2 Data: 02/11/16	Trattamenti:		autostrade per l'italia
Documento di proprietà di		Foglio: 1 di 1	
Autostrade per l'italia S.p.A.		A3 Scala: 1:25	
riprod. vietata a termini di legge		Atlantia	